



netro

a product by  Gedung and 



Netro House V.1



Netro House V.2

Pioneering the Industrial-based, Smart Net-zero, and Growing Modular House System

WIK A Gedung—a leading in modular construction in Indonesia since 2017 (with projects such as Covid Hospital, Mandalika Paddock, and IKN)—together with DEX, an innovator in sustainable technology and design, proudly present NETRO: Pioneering the Industrial-based, Smart Net-zero, and Growing Modular Homes. This groundbreaking innovation seamlessly integrates smart technology, energy efficiency, and modular design to create a truly eco-friendly home. More than just a residence, NETRO embodies the future of living by embracing zero-emission principles and a smart energy system.

Designed with sustainable materials and built using an efficient modular construction method developed by WIK A Gedung and equipped with smart Net-Zero box and application developed by DEX, NETRO offers a scalable living solution that grows with its occupants, reducing waste, optimizing resources, and ensuring a minimal environmental footprint. This forward-thinking approach makes NETRO not just a home, but a symbol of future-proof, sustainable living—smart, adaptable, and eco-conscious.

What Makes it Net-zero?

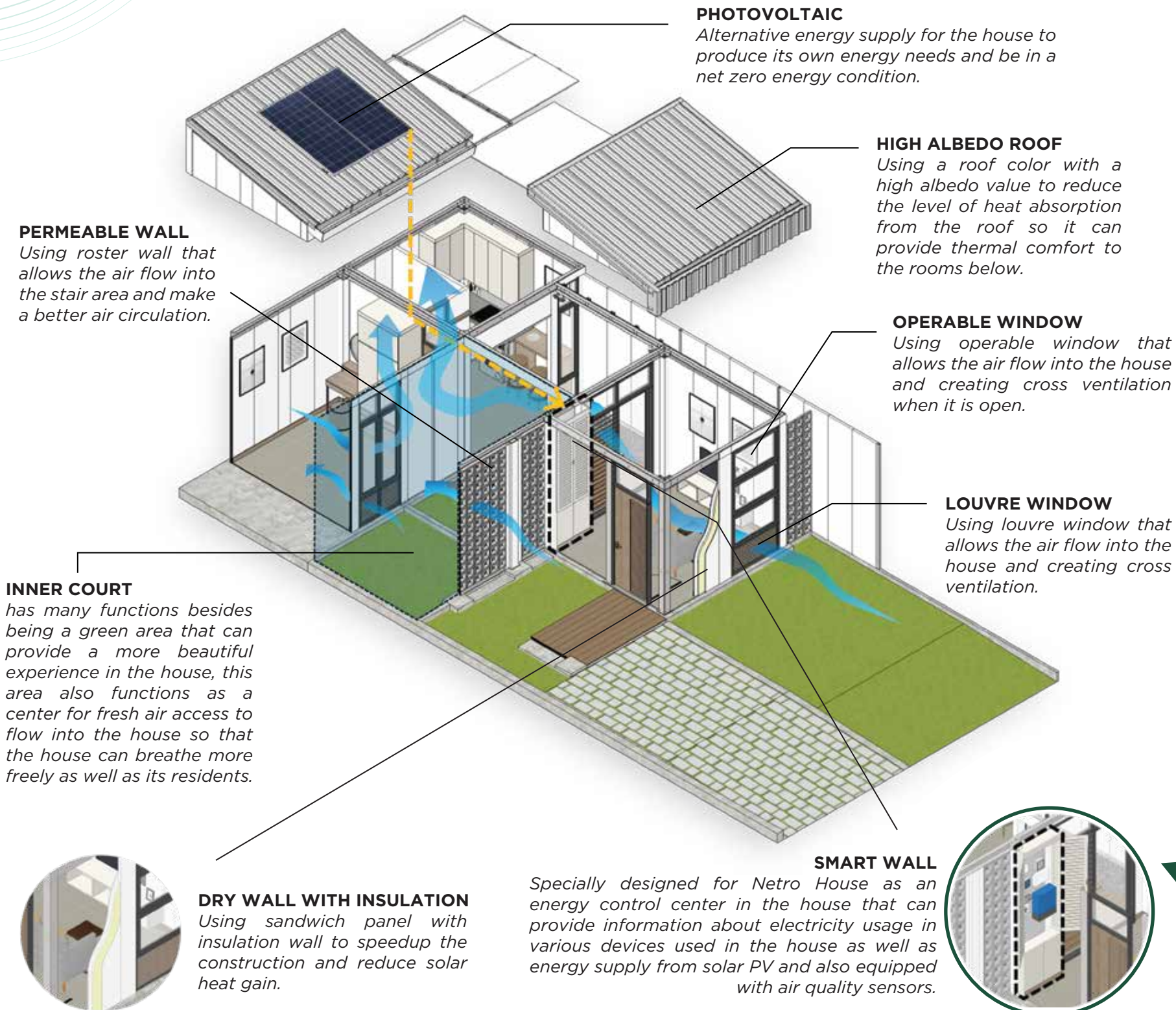

Netro House Growing Scheme

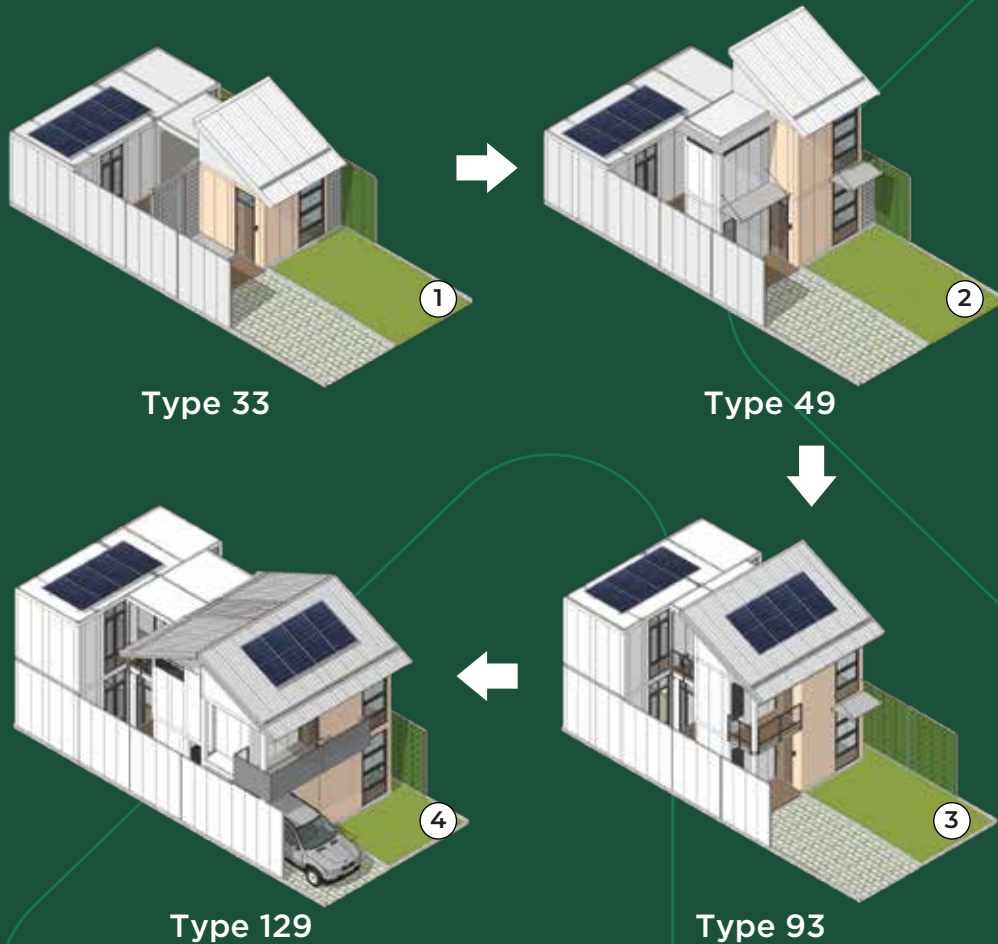

NETRO by WIK A Gedung and Dex Urban Solution is built on the innovative "growing house" concept, enabling homeowners to start with a compact, cost-effective unit and expand their living space over time. This flexibility allows the home to adapt seamlessly to the evolving needs of its occupants, whether for growing families, changing lifestyles.

The modular design ensures that expansions are efficient, avoiding the need for disruptive or wasteful renovations while maintaining the integrity of the original structure. 60% faster than conventional construction, highly consistent quality.

It's an ideal solution for urban and rural communities alike, accommodating diverse life stages while maintaining quality, comfort, and style. Whether starting small or planning for future growth, this system supports homeowners in creating a home that evolves with them.

Netro Smart Net-zero (NZ)





Netro Modular House Growth

Type 33

Land Area: 105 m² (7m x 15m) **suggested*

Building Area: 33 m²



Floor Plan

1. Living Room
2. Innercourt
3. Master Bedroom
4. Bathroom
5. Kitchen + Dining

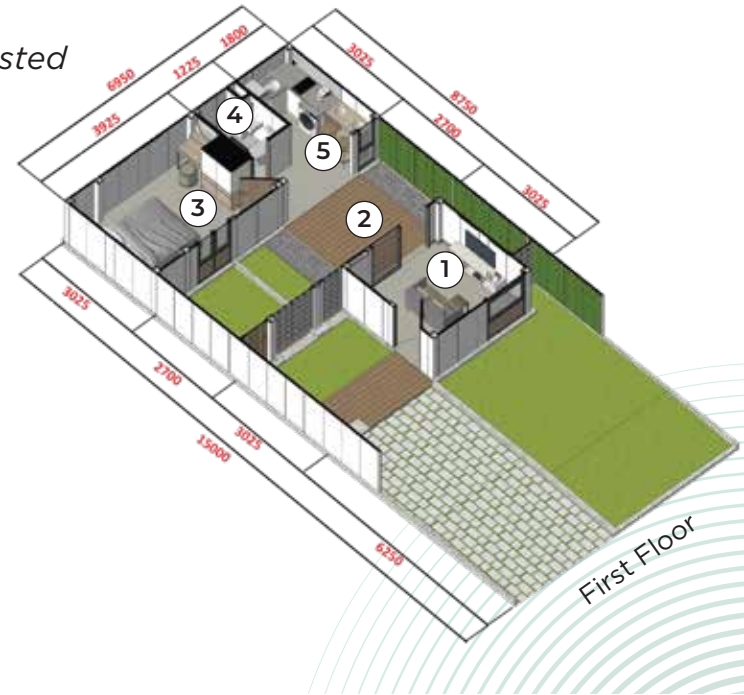
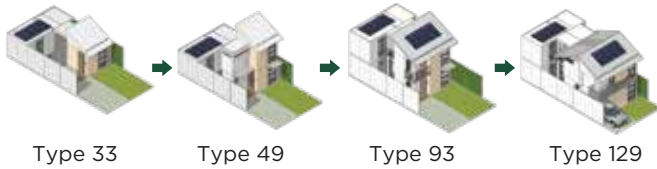

Netro Modular House Growth

Type 49

Land Area: 105 m² (7m x 15m) **suggested*

Building Area: 49 m²



Floor Plan

- | | |
|-------------------|---------------------|
| 1. Living Room | 5. Bathroom |
| 2. Staircase | 6. Kitchen + Dining |
| 3. Innercourt | 7. Study Room |
| 4. Master Bedroom | |





Netro Modular House Growth

Type 93

Land Area: 105 m² (7m x 15m) **suggested*

Building Area: 93 m²



Floor Plan

- | | | |
|-------------------|---------------|--------------|
| 1. Living Room | 6. Kitchen | 11. Bathroom |
| 2. Staircase | 7. Balcony | 12. Laundry |
| 3. Dining | 8. Study Room | |
| 4. Master Bedroom | 9. Innercourt | |
| 5. Bathroom | 10. Bedroom | |

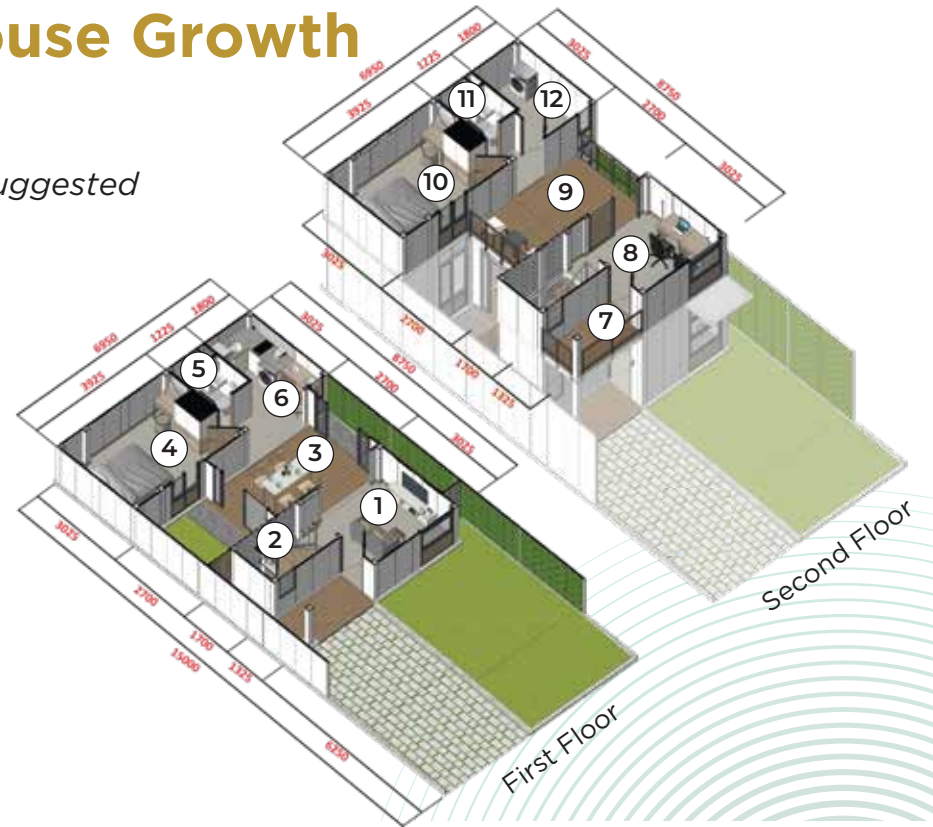

Netro Modular House Growth

Type 129

Land Area: 105 m² (7m x 15m) **suggested*

Building Area: 129 m²



Floor Plan

- | | | |
|----------------|-------------------|--------------|
| 1. Living Room | 7. Balcony | 13. Bathroom |
| 2. Staircase | 8. Master Bedroom | 14. Laundry |
| 3. Dining Room | 9. Bathroom | |
| 4. Bedoom | 10. Study Room | |
| 5. Bathroom | 11. Innercourt | |
| 6. Kitchen | 12. Bedroom | |



Netro V.1 General Specification

Structure

Foundation: Slab concrete
Frame structure : SS400 Steel

Floor Finishing

Dry area : GRC Sandwich Panel t. 75mm + parquet or similar material (klik system)
Wet area : GRC Sandwich Panel t. 75mm + waterproofing + PVC/ SPC flooring
Terrace Inner court : WPC Decking

Wall Finishing

Dry area : GRC Sandwich Panel 50mm + cladding (klik system)
Wet area : GRC Sandwich Panel 75mm + waterproofing + waterproof cladding

Ceiling

Indoor area : WPC or PVC or similar material (klik system)
Outdoor area : WPC or PVC or similar material (klik system)

Doors & Windows

Unit door : Engineering door
Windows : Aluminum frame + clear glass

Roof

Main : UPVC single layer
Deck : GRC superpanel 18mm + waterproofing
Canopy : Hollow Canopy + solarflat

Sanitary

Closet : Two-piece toilet + eco washer
Washbasin : Half-hung washbasin
Shower head : Fixed shower head
Floor drain & Clean Out : Standard type

*This specifications is currently under development, may be updated without prior notice.

*For more information about **netro V.2**, please contact us.



Your Home Your Vision Your Net-Zero Future

For developers with unique project requirements or homeowners seeking a personalized touch, Netro's modular design allows for modifications and semi-customization. Whether adjusting layout configurations, incorporating additional sustainable features, or aligning with specific aesthetic visions, our team can refine the design to match your exact needs.*

*Custom modifications will extend the delivery timeline.

For more information and to place an order please contact



0811 920 301



modular@wikagedung.id



www.modular.co.id

www.wikagedung.co.id
www.dexurbansolution.com

This product knowledge is copyright of PT Wijaya Karya Bangunan Gedung TBK and PT Dex Solusi Transit